

See... #1
H. Mason's
ALBUM

PROVIDENCE PRESERVATION SOCIETY

RECORDS OF

PLAT 16
Lot 202

#357 BENEFIT STREET.....Wood

#189 BENEFIT STREET IN 1824

- 1775 DAVID LAW SELLS FOR £,020 £ LAWFUL MONEY TO WILLIAM WEST TWO SEVERAL PIECES OF LAND IN PROVIDENCE CONTAINING THE WHOLE ABOUT ELEVEN ACRES MORE OR LESS. ONE PIECE WHEREOF IS BOUNDED N/LY ON POWER'S LANE; E/LY ON A HIGHWAY; S/LY ON LAND OF REBECCA WILLIAMS AND W/LY ON BENEFIT OR BACK STREET....THE OTHER PEICE...DB 20.308
- 1776 WILLIAM WEST, YEOMAN, SELLS FOR 690 £ LAWFUL MONEY TO GEORGE CORLIS MERCHANT, A CERTAIN LOT OF LAND BEING IN SAID PROVIDENCE, CONTAINING ABOUT 10 ACRES MORE OR LESS, BUTTED AND BOUNDED: W/LY ON BACK OR BENEFIT STREET; S BY REBEKAH WILLIAMS; E/LY BY A HIGHWAY; N/LY ON POWER'S LANE...AND IS THE SAME I PURCHASED OF DAVID LAW...DB 20.366
- 1780 GEORGE CORLIS, YEOMAN SELLS FOR 1,190 GOOD SPANISH MILLED DOLLARS TO JOHN INNES CLARKE AND JOSEPH NIGHTINGALE, MERCHANTS IN COMPANY THREE PIECES OF LAND SITUATED ON THE S SIDE OF POWER'S LANE IN SAID PROVIDENCE AND DESCRIBED AS FOLLOWS: TO WIT, THE FIRST PEICE, BEGINNING AT THE NORTHWEST CORNER WHERE THE SAID POWER'S LANE AND THE BACK STREET MEET. THENCE SOUTH 82° AND AN HALF EAST AND BOUNDED NORTHERLY ON SAID POWER'S LANE THIRTEEN POLES AND THREE TENTHS TO A STAKE IN THE GROUND. THENCE SOUTH TWENTY TWO DEGREES AND AN HALF EAST ONE HUNDRED TWELVE AND EIGHT TENTHS. THENCE WESTERLY AND BOUNDING SOUTHERLY ON MY OTHER LAND UNTIL IT COMES TO A STAKE IN THE GROUND IN THE EAST SIDE OF SAID BACK STREET. THENCE NORTH 24° AND ONE HALF WEST ONE HUNDRED AND TWENTY TWO FEET AND THREE QUARTERS AND BOUNDING WESTERLY ON SAID BACK STREET UNTIL IT COMES TO THE FIRST MENTIONED CORNER...THE SECOND PEICE....DB 20.573
- 1790 WILL..GEORGE CORLIS:....."GIVE AND DEVISE TO MY SON JOHN.."ALSO THE REMAINDER OF MY LAND NOT HERETOFOR DEVISED WHICH I PURCHASED OF WILLIAM WEST ESQUIRE, BEING THREE LOTS.."...WILLS 11.300
- 1790 JOHN CORLIS OF PROVIDENCE, MERCHANT, FOR 200 £ LAWFUL MONEY SELLS TO JOSEPH NIGHTINGALE, MERCHANT, ONE CERTAIN LOT OF LAND SITUATED IN PROVIDENCE ON THE E SIDE OF THE RIVER BOUNDED AND DESCRIBED AS FOLLOWS: BEGINNING FOR A NORTHWEST CORNER AT A STAKE STANDING IN THE EAST LINE OF BENEFIT STREET AND WHICH IS ALSO A BOUND BETWEEN THE LOT HEREBY CONVEYED AND A LOT OF LAND ADJOINING NORTHERLY BELONGING TO MESSRS. CLARKE AND NIGHTINGALE, FROM SAID STAKE BOUNDING WEST ON SAID BENEFIT STREET, RUNS SOUTHERLY 113'.2, THEN MAKING A CORNER RUNS EAST 15° SOUTH TWELVE RODS AND THREE TENTHS OF A ROD THEN AGAIN MAKING A CORNER AND BOUNDING EAST ON LAND OF THE GRANTOR RUNS NORTH TWENTY TWO AND ONE HALF° WEST, ONE HUNDRED EIGHT FEET THREE TENTHS OF A FOOT, TO ONE OTHER STAKE BEING ALSO A BOUND BETWEEN THE LOT HEREBY CONVEYED AND THE SAID LOT BELONGING TO SAID CLARKE AND NIGHTINGALE, THENCE AGAIN MAKING A CORNER AND BOUNDING N/LY ON THE SD LOT OF CLARKE & NIGHTINGALE RUNS ON A STRAIGHT LINE WESTERLY TO THE AFOREMENTIONED BEGINNING BOUND. THE LOT OF LAND HEREBY CONVEYED AND ABOVE

MORE.....

#357 BENEFIT STREET....CONTINUED.....

DESCRIBED CONTAINS BY MEASURE ONE QUARTER OF AN ACRE THIRTY THREE RODS AND ONE TENTH OF A ROD, AND IS THE SAME WHICH WAS DEVISED TO THE GRANTOR IN AND BY THE LAST WILL AND TESTAMENT OF HIS LATE HONORED FATHER GEORGE CORLIS, DECEASED, IS LOT #5 AS SURVEYED AND DESCRIBED ON A PLAT MADE BY BENJAMIN WEST, SURVEYOR ON THE 10TH DAY OF MAY 1790 AND RECORDED IN THE REGISTRY OF LAND EVIDENCE IN SAID PROVIDENCE...DB 23.1

- 1790 JOHN CORLIS OF PROVIDENCE, MERCHANT, SELLS FOR 60 £ LAWFUL MONEY TO JOSEPH NIGHTINGALE OF PROVIDENCE, MERCHANT, A LOT OF LAND IN THE S/LY PART OF THE TOWN AND BUTTED AND BOUNDED AS FOLLOWS: S BY WILLIAMS THAYER 110.6"; W BY BENEFIT STREET 70 $\frac{1}{2}$ '; N BY JOSEPH NIGHTINGALE...DB 21.710
- 1790 WILLIAM STREET LAID OUT BY AGREEMENT OF JOHN CORLIS, REBECCA WILLIAMS AND JOSEPH NIGHTINGALE....DB 22.294
- 1798 CHACE INDEX CARDS: JOSEPH NIGHTINGALE HEIRS....W ON BENEFIT ST; S ON REBECCA WILLIAMS....54' SQUARE...3 STORIES...WOOD. TWO outhouses EACH 22' x 36'...2 STORIES...WOOD. ONE WOODHOUSE 13'x54'... 1 STORY...WOOD.
- JOSEPH NIGHTINGALE HEIRS....E ON BENEFIT STREET 53'; S ON RICHARD LEE 102'...A LOT...(JOHN WARD TO JOSEPH NIGHTINGALE AND JOHN I. CLARK...BEGIN AT NE CORNER OF TRIANGULAR LOT OF RICHARD LOW...GO S BOUND E ON BENEFIT STREET TO REBECCA WILLIAMS....GO W BOUND S ON WILLIAMS 102 $\frac{1}{2}$ '...GO N TO SW CORNER TRIANGULAR LOT. JOHN WARD SOLD TO RICHARD LOW..GO E BOUND N ON LAW TO 1ST MENTIONED BOUND.) LAW, LOW, LEE MAY BE THE SAME.
- 1807 JOHN INNES CLARKE QUIT CLAIMS TO JOSEPH NIGHTINGALE...." ALSO A LOT OF LAND WITH DWELLING HOUSE AND OTHER BUILDINGS, SAID HOUSE BEING THE MANSION HOUSE IN WHICH ELIZABETH NIGHTGALE NOW RESIDES"...DB 30.318
- 1809 FIRE RECORD: ELIZABETH NIGHTINGALE...EAST SIDE OF BENEFIT STREET SELF-OCCUPIED...WOOD...54' FRONT, 54' FRONT TO REAR...3 STORIES HIGH FRONT AND REAR...POLICY #1172 VOL. 3
- 1809 FIRE RECORD: ELIZABETH NIGHTINGALE...OUTBUILDINGS BACK OF HOUSE, SITUATED ON BENEFIT STREET AND NOW OCCUPIED BY HERSELF FOR PURPOSE OF DWELLING HOUSE, KITCHEN, BARN, AND STABLES. SAID OUTBUILDINGS ARE....POLICY #1173 VOL. 3
- 1814 PROVIDENCE DIRECT TAX (LEVIED TO PAY FOR THE WAR OF 1812)
ELIZABETH NIGHTINGALE, SUBSCRIBER:

PROPERTY LISTED:
E BY MR. CARRINGTON....200'
S BY WILLIAMS STREET...170'
W BY BENEFIT STREET....290'
N BY POWER STREET.....216'

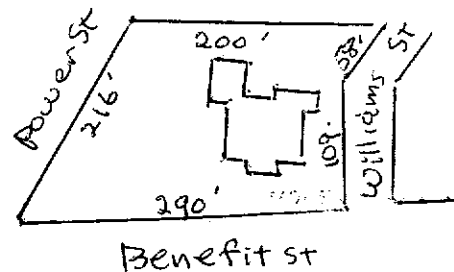

#357 BENEFIT STREET.....CONTINUED

ON THE ABOVE ARE:

- 1 HOUSE 52' FRONT AND BACK....3 STORIES
- 1 OUTHOUSE 36'x26'...2 STORIES
- 1 SHED 55'x17½'
- 1 BARN 36'x24'...2 STORIES

"THE OUTBUILDINGS ARE OLD AND OUT OF REPAIR. 1 LOT FRONTING ON BENEFIT STREET MEASURES 53' FRONT AND GOES BACK TO LAND OF WILLIAM THAYER 80', MEASURING ON SAID THAYER'S LOT 53', OCCUPIED AS A GARDEN. ALL THE ABOVE BUILDINGS ARE OF WOOD."

- 1814 ELIZABETH NIGHTINGALE ET AL SELL TO NICHOLAS BROWN ESQUIRE FOR \$16,500, A CERTAIN LOT OF LAND WITH THE MANSION HOUSE AND OTHER BUILDINGS THEREON STANDING IN PROVIDENCE ON THE E/LY SIDE OF BENEFIT STREET AS ESTABLISHED BY THE TOWN IN 1801, WITH ALL THE APPURTENANCES THEREOF....BOUNDED W BY BENEFIT STREET 284'; S BY WILLIAMS STREET 109' AND 58'; E BY EDWARD CARRINGTON 198'; N BY POWER STREET 212'...ALSO ANOTHER LOT IN THE S/LY PART OF PROVIDENCE ON THE W/LY SIDE OF BENEFIT STREET WHICH JOHN WARD FORMERLY BOUGHT OF RICHARD LOW, AND BEING SAME JOHN WARD SOLD TO JOSEPH NIGHTINGALE IN DB 38.18
- 1854 THIS PROPERTY WAS TAXED TO JOHN CARTER BROWN.
(SEE 1855)
- 1855 STABLES WERE BUILT BY THOMAS TEFFT. DRAWING BY TEFFT DATED 21/4/55 IN THE JOHN HAY LIBRARY COLLECTION OF TEFFT DRAWINGS (BROWN UNIVERSITY).
- 1862 LIBRARY WING BUILT IN 1862 BY JOHN CARTER BROWN TO ACCOMMODATE HIS COLLECTION OF AMERICANA, NOW THE BASIS OF THE JOHN CARTER BROWN LIBRARY AT BROWN UNIVERSITY...(JOHN NICHOLAS BROWN)
- 1875 PROPERTY TAXED TO SOPHIA AUGUSTA BROWN, WIDOW
- 1880 ADDITION ON SOUTH BUILT...(JOHN NICHOLAS BROWN)
- 1900 PROPERTY TAXED TO S.A.SHERMAN, WIDOW, WM. W.
- 1921-
- 1923 TAXED TO JOHN NICHOLAS BROWN. PANELLING IN THE DINING ROOM WAS INSTALLED. IT IS ENGLISH, FROM THE OLD CHANTRY HOUSE, NEWARK. THE HOUSE DATES BACK INTO THE 16TH CENTURY. THIS PANELLING WAS INSTALLED IN THE CHANTRY HOUSE C 1730.....(JOHN NICHOLAS BROWN)
- 1961 OLD VIEW OF THE HOUSE, A LARGE WATERCOLOR DATED C 1814? NOW OWNED BY (JOHN NICHOLAS BROWN)
- 1962 THIS MANSION HOUSE IS STILL OWNED BY THE BROWN FAMILY AND IS KNOWN AS THE NIGHTINGALE-BROWN HOUSE. JOHN NICHOLAS BROWN IS THE PRESENT OWNER AND OCCUPANT.

Providence Preservation Society

24 MEETING STREET PROVIDENCE 3, RHODE ISLAND TEMPLE 1-1440

Records of

#357 BENEFIT STREET...Wood

Flat 16
Lot 202

(#189 Benefit Street in 1824)

- 1775 David Law sells for 1020 £ lawful money to William West two several Pieces of Land in Providence containing the whole about eleven acres more or less. One Piece whereof is bounded N/ly on Power's Lane; E/ly on a Highway; S/ly on Land of Rebecca Williams and W/ly on Benefit or Back Street...the other piece...DB 20.306
- 1776 William West, yeoman, sells for 698 £ Lawful money to George Corlis merchant, a certain lot of land, being in said Providence, containing about 10 acres more or less, butted and bounded, W/ly on Back or Benefit Street; S by Rebekah Williams; E/ly on a Highway; N/ly on Power's Lane...and is the same I purchased of D Law. DB 20.366
- 1780 George Corlis, yeoman, sells for 1190 good Spanish Milled Dollars to John James Clarke and Joseph Nightingale, merchants in Company, three pieces of land situated on the S side of Power's Lane in said Providence and described as follows; to wit, the first piece, beginning at the N/W Corner where the said Power's Lane and the Back Street meet. Thence S 22° and an Half E and bounded N/ly on said Power's Lane 13 Poles and 3/10 to a Stake in the ground. Thence S 22° and an half E 112 and 8/10. Thence W/ly, and bounding N/ly on my other Land until it comes to a Stake in the Ground in the E side of said Back Street. Thence N 24° and One Half West 122 Feet and 3/4 and bounding W/ly on said Back Street until it comes to the first mentioned corner...the second piece...DB 20.573
- 1790 WILL: George Corlis:... I give and devise to my son John...also the remainder of my land not heretofore devised which I purchased of William West Esquire, being three lots... Wills 11.300
- 1790 John Corlis of Providence, merchant, for 200 £ Lawful Money sells to Joseph Nightingale, merchant, one certain lot of land situated in Providence on the S side of the River bounded and described as



Recorded
1809

Wills p. 469-70-71

SCHEDULE of FURNITURE etc., in and about
the House of the late Joseph Nightingale
deceased...Viz.....

In the Parlor

1	Looking Glass	\$	30.
1	Table		9.
2	Sophette @ \$14		28.
12	Mahogany Chairs @ \$6		72.
7	China Pots @ \$1		7.
3	Cornices and Curtains for Windows @ \$7		21.
1	Tea Set of China		15.
4	Tea Trays @ \$2		8.
1	Cady		3.
1	Carpet		60.

Dining Room

1	Mahogany Side Board \$30...1 Mahogany Tea Table \$5		35.
7	Ditto Chairs @ \$2.50		17.50
1	Sopha \$18 1 Looking Glass \$15		33.
1	Pair Andirons, 1 pair Shovels, Tongs and Hooks		13.
8	China Flower Pots @ .75		6.
1	Sett of China (Tea Sett)		3.50
1	Table Sett Ditto		90.
1	Service of Glass		40.
2	Tea Trays @ \$.33		2.66
3	Window Curtains @\$4		12.
1	Carpet		10.

Bedroom below

1	Bedstead, bed, and furniture		26.
1	Mahogany Desk and Bookcase		25.
1	Ditto Dressing Table		
1	Looking Glass \$6..4 Chairs @ \$1.50 \$6 ..1 Carpet \$1		13.

Back Dining Room

1	India Couch \$10..1 Mahogany Dining Table \$5		15.
6	Chairs @ \$6..1 Table Set of China \$40		46.
1	Looking Glass \$6..1 Carpet \$10		16.
1	Pair Andirons, Shovel and Tongs		3.

Lower Entry

2	Mahogany Tables @ \$6		12.
1	Old Piano Forte		50.
1	Carpet \$20..1 Lamp \$5		25.
6	Chairs @ \$1..\$6 1 Stair Carpet \$5		11.
	Carried Forward		<u>765.66</u>

Joseph Nightingale Inventory...continued

Brought Forward

\$ 765.66

Kitchen

3	Tables etc @ \$4	\$ 12.	
6	Chairs @ 50¢	3.	
	Pots, kettles etc	20.	
1	Pair Andirons..1 pr Shovel and Tongs	3.	38.

South Entry

One Clock

40.

Second Floor Entry

6	Chairs @ \$1.75		10.50
1	Carpet		20.

Parlour Chamber

1	Bedstead, Bed and furniture	\$ 55.	55.
2	Window Cornices and Curtains @ \$7	14.	14.
1	Toilet \$5 1 Looking Glass \$18	23.	
6	Chairs @ \$3	18.	
1	Carpet \$27..1 Wash Stand \$3.50	30.50	140.50

Dining Room Chamber

1	Bedstead, Bed and furniture	\$ 46.	
3	Window Curtains @ \$4	12.	
1	Bureau \$20..1 Looking Glass \$10	30.	
1	Dressing Table and Glass	9.	
7	Chairs @ \$2.50	17.50	
1	Carpet \$16..1 Wash Stand \$3	19.	133.50

Kitchen Chamber

6	Chairs	\$ 1.50	
1	Carpet \$5..1 Case of Drawers \$15	20.	
2	Bedsteads, Beds and Furniture @ \$15	30.	57.50

Drawing Room not furnishedThird Story Entry

2	Mahogany Tables @ \$6		12.
---	-----------------------	--	-----

S W Chamber

1	Bedstead, Bed and Furniture	\$ 26	
6	Chairs @ \$1	\$6 6.	
1	Bedstead \$14..1 Dook'g Glass \$7..1 Carpet 27.		59.00

Beavreau

Joseph Nightingale Inventory...continuedN W Chamber

1 Bedstead, Bed and furniture	\$ 22.	
1 Beaurean	14.	
1 Looking Glass	12.	

Balance brought forward

\$ 1391.66

N E Chamber

1 Bedstead, Bed and Furniture	20.	
3 Chairs @75¢ each	2.25	
1 Looking Glass	1.50	23.75

S E Chamber

1 Bedstead, Bed and Furniture	20.	
3 Chairs @ 75¢ ea	2.25	
1 Looking Glass	1.50	23.75
12 Pair Sheets @ 3.75	45.	
18 Pair Pillow Cases @ 50¢ pr	9.	
18 Tablecloths @ \$2	36.	
24 Napkins @\$1	24.	
48 Common Diaper ditto @ 20¢ ea	9.60	
250 Books @ 75¢	187.50	
200 Plate @1.00	220.	
<u>Stable</u> 5 Doz Knives and Forks @ \$3	15.	546.10
1 Coach and Harness	130.	
1 Phaeton without ditto	140.	
1 Chaise and Harness	30.	
1 Chaise and ditto	25.	
1 Pair Bay Horses	300.	
1 Gray Horse	80.	
1 Old Saddle and Bridle	5.50	
1 Sleigh	20.	730.50

Benjamin F Carlile)
Oliver Mason) Appraisers

$\frac{1}{4}$ part of Brig "Sukey"..Appurtenances, complete 300.
 $\frac{1}{3}$ part of Ship "Zenobia"..Sold at Auction 3166.

Recorded 17th August 1809

COLONEL JOSEPH NIGHTINGALE HOUSE

Address: 257 Benefit Street, Providence, Providence
County, Rhode Island.

Plat 16, lot 420; this lot was 169 Benefit Street
in 1824.

An addendum to
Colonel Nightingale House
257 Benefit Street
Providence, Rhode Island
in HABS Catalog (1941)

Present Owner
and Occupant: John Nicholas Brown

Present Use: Residence.

Brief Statement
of Significance: This house was built for Colonel Joseph Nightingale,
wealthy partner in a Providence shipping firm, and
has been owned by the Brown family since 1814.
Built in 1791, this large, three-story frame build-
ing is one of the most elegant houses in Providence.

PART I. HISTORICAL INFORMATION

A. Physical History

1. Original and subsequent owners:

1791 Land owned by Joseph Nightingale.

1814 Elizabeth Nightingale subscriber in Ass. tax
descriptions in the Rhode Island Historical
Society, Providence, for the 1814 Providence
direct tax to the federal government:

Property listed:
E by Mr. Carrington...200'
S by Williams Street...170'
W by Benefit Street...200'
N by Providence Street 27.5'

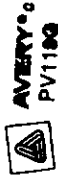

The outbuildings are old and out of repair. 1 lot fronting on Benefit Street measures 53' front and back to land of Williams Thayer 33', measuring on said Thayer's lot 53', occupied as a garden. All the above buildings are of wood.

1814 Elizabeth Nightingale et al sell to Nicholas Brown Esq., a certain lot of land with other buildings... Deed Book 36, page 18, in Providence City Hall.

In the Brown family since 1814.

2. Date of erection: 1791
3. Architect: The architect is thought to be Caleb Crossbee, who built the First Congregational Church of 1795 (burned in 1814). Caleb Crossbee became the owner of Joseph Brown's copy of James Gibbs' Book of Architecture, 1728, after Brown's death in 1780.
4. Notes on alterations and additions:
 - 1855 Stables were built and designed by Thomas Tefft. Drawing by Tefft dated 21 4/5/ in the John Hay Library Collection of Tefft drawings (Brown University)
 - 1862 Library wing built in 1862 for John Carter Brown to accommodate his collection of Americana, now the basis of the John Carter Brown Library at Brown University.
 - 1880 Addition on south built.
 - 1923 Panelling in the dining room was installed in 1923. It is English, from the Old Chantry House, Newark. The house dates back into the 16th century. This panelling was installed in the Old Chantry House c 1730.
5. Important old views:
 - 1961 Old view of the House dated c 1812 () now owned by John Nicholas Brown. (Large watercolor).
6. Sources of information: Antoinette Brewster Downing, Early Homes of Rhode Island (Richmond, Virginia: Garrett and Massie, 1937) pp. 269, 296, 298-301, 304, 317, 351, 352, 382.
Henry-Russell Hitchcock, Jr., Rhode Island Architecture (Providence: Rhode Island Museum Press, 1937), p. 25.

Norman Morrison Ishaan, "Providence," White Pine Series of Architectural Monographs, Vol. IV, No. 3 pp. 7-10. Great Georgian Houses of America (Architects' Emergency Committee, New York, 1933, 1937).

Richard Pratt, The Second Treasury of Early American Homes (New York: Hawthorn Books, Inc., 1954), Vol. II. Providence Magazine, Board of Trade Journal, December 1914, p. 788. (In Rhode Island Historical Society).

Old Providence, A Collection of Facts and Traditions Relating to Various Buildings and Sites of Historic Interest in Providence, (Providence, Rhode Island: The Merchants National Bank of Providence, 1918), p.35.

Prepared by Antoinette F. Downing and Elvira Cowdrey
for the Providence Preservation Society
August 1961.

PART II. ARCHITECTURAL INFORMATION

A. General Statement

1. Architectural character: This large, three-story frame house is one of the most elegant mansions in Providence.
2. Condition of fabric: Excellent.

B. Technical Description of Exterior

1. Overall dimensions: 52' (five bays) x 52' main block three stories high plus cellar facing west. About 30' x 36' library addition one story high at the northeast corner. Addition along the south side of the main block, 12' deep, two stories high. 30' x 21' kitchen wing at the southeast corner, two stories high.
2. Foundations: Regular ashlar limestone.
3. Wall construction: Probably frame covered with clapboards, with heavy wood quoins.
4. Porches: One-story entrance porch with Ionic columns at the corners, full Doric entablature and roof balustrade. Porch floor up four steps.
5. Chimneys: Four brick chimneys in main block.
6. Openings:
 - a. Doors: The main entrance is in the center bay which is stepped out slightly and marked by quoins. The

door is paneled with four rectangular panels in the upper half and a diamond shape in the lower half. The door is in a pilastered frame with side lights and a semi-circular top light. The stepped out center bay has a Palladian window at the second floor level above the entrance porch, and a pediment at the top.

- b. Windows: six over six light double hung wood windows. Rusticated wood frames on the first and second floors with denticulated cornices. Simple molded frames on the third floor. Adjustable louvered shutters on all three floors.

7. Roof:

- a. Shape, covering: Hip roof with gable-roofed monitor; covered with standing seam metal roof.
- b. Cornice: Modillion cornice with denticulated bed mold on main roof; denticulated cornice on monitor. Balustrade with turned balusters on main roof; Chinese Chippendale balustrade on monitor.

8. Technical Description of Interior

- 1. Floor plans: Originally the plan was a central hall, four rooms, two interior chimney plan, with two chimneys on east exterior wall.

Parlor. (northwest room) Walls and ceilings plastered. Main doorway: similar to hall--broken scroll with modillion and dentil course, pedestal and bust frieze, flat carved Adam detail. Other doorways and windows: crosspieces at top, curved base, moldings carved with classic motives. Doors are later four paneled. Windows have shutters in reveals and are recessed to floor--no window seats. Cornice reeded, with modillions below and then narrow band of fret. Wainscoting paneled, recessed; chair rail with band of paterae and fluting, and beaded below that. Two-story mantelpiece with Adam frieze, broken scroll pediment, modillion, dentils; pedestal and bust as in doorway; marble hearth, marble facing. Floors--probably hard pine about 3" board.

Dining Room: (southwest room) Pine paneled room, Georgian, English, 1730 from Old Chantry House, woodwork installed in 1923. Full panelling around entire room, recessed. Cornice molded--with dentil course; chair rail reeded. Doorways with flat cornice top, egg and dart variant in one molding; oared molding richly carved, acorn and oak

COLONEL JOSEPH NIGHTINGALE HOUSE
HABS No. RI-164 (Page 5)

leaf carved swag below the ears. Six panel doors, egg and dart variant on molding around recessed panels. Very good shell cupboard between windows on west wall, with broken scroll above, supported on consoles. Two-story mantel repeats broken scroll of cupboard, oak and acorn swags of doorway; engaged columns on top story supported on brackets; eared molding around fireplace, carved. Floors same as hall and parlor and southeast room.

Southeast room of main block: Little detail left. Plaster walls (papered modern). Molded cornice (plaster). Molded window and door frames, probably original. Doors, later, four panel mahogany. One-story marble mantel with Adam detail installed at east end of room, away from original chimney; black marble hearth edged with white marble.

Library: Built on, at northeast corner, in addition c 1862. Very fine Victorian room. Rectangular room with recessed, coved, oval in ceiling framed with classic carved moldings, of plaster. Walls hung with red silk damask. Black walnut bookcases and woodwork. Plain molding for doorways and window framings and chair rail; smooth unpaneled black walnut wainscoting. One-story black walnut carved mantel at east end flanked by round-headed bookcases with carved moldings; diamond wire in front of glass. Room cornice of plaster with classic garland molding and boss molding. Floors--oak in short herringbone pattern. Crystal chandelier.

Central stair hall: Hall runs through center of house.

Stairway (main) set at back of hall; two runs with landing across back wall. Round-headed landing window--molded key block. Stairway rising two flights; three slender spiral balusters to each step, each with different twist, cut scroll decoration on step end, string course finished with reeded member. Rail scroll around newel post, newels and posts are in form of Roman Doric colonette. Rails ramp over posts; shadow rail on wall.

Two large brass case locks for hall doors with keys. Original doors eight panel. Hall doorways have broken scroll pediments, Ionic cushion frieze, dentil course below. Frames are mitred with crossettes at top and mitred curve at base. Doors are later four panel mahogany. Front door with Palladian side lights and lunette has broken pediment to allow for lunette. Lunette has plain key block. Side lights have three panel shutters.

COLONEL JOSEPH NIGHTINGALE HOUSE
HABS No. SI-154 (Page 5)

Cornice in hall molded with guilloche and reeded below. Chair rail is reeded; wainscoting wooden with slender raised molding marking it into panels.

Second floor plan: Central hall plan, similar to first floor, two rooms deep with the two south rooms enlarged by the addition on the south side of the house; closets and baths between the rooms. Flooring--wide board flooring.

Third floor: Similar to second but with simpler trim and without the chair rail.

2. Wall and ceiling finish: Plaster walls and ceilings; walls papered, painted or hung with fabrics. Reeded, fretted and other types of ceiling cornices throughout.
3. Doorways: Six panel doors with raised panels. Doorways with double molded architraves and dog-eared tops and flared bottoms.
4. Trim: Reeded chair rail and wainscot throughout.
5. Hardware: Silver plated hardware throughout.
6. Lighting: Electric.

D. Site

1. General setting and orientation: The house faces west on a large lot with gardens and yard on the south, west, and north sides, and with service yard and buildings on the east.
2. Enclosures: Brick wall with limestone trim at the west and south sides with wooden gates on the south for the automobile entrance, and on the west leading to the main entrance of the house. Wood fences around other parts of the house.
3. Outbuildings: A two-story brick garage is east (behind) the house.
4. Walks; driveways: Brick, except at the front and south sides, large brown flagstones.
5. Landscaping: The enclosed yard is eight steps above the sidewalk at the west (front) side and slopes up slightly to the rear. The garden is informally landscaped with shrubs, trees, flowers, and lawn.

Prepared by Samuel N. Overby, Architect
National Park Service
and Antoinette F. Downing
for the Providence Preservation Society
August 1961.