

PROVIDENCE PRESERVATION SOCIETY

Records of

Flat 16
Lot 467

formerly #84

#166 WICKENDEN STREET

Built 1795-98...By Samuel Allin

- 1795 Christopher Sheldon sells for \$425 to Samuel Allen, mariner, one certain lot of land lying in the S/ly part of Providence, bounded: S by Wickenden Street 40'; W by heirs of John Jones dec. 87'; N by grantor 40'; E by Simeon Ingraham 84'...Deed Book 24.152
- 1798 Samuel Allen: House and Lot...Cady's " Owners and Occupants of the Lots, Houses and Shops in the Town of Providence, R I in 1798"
- 1808 FIRE RECORD: Samuel P Allen (son of Samuel) Wickenden Street...His DWEL- LING HOUSE...self-occupied for the purpose of living...wood...36' in front and 30' front to rear...2 stories high front and rear. FR 2.564
- 1810 Division of the Estate of Samuel Allen: The Mansion House set off to his 2 daughters: Charlotte S Allen and Harriet S Allen by their paying to the 2 brothers William^H Allen and Samuel Allen jr \$1000, valuing the said daughters' parts in said house at \$4,000. All the rest and residue of said Samuel's real estate we set off to the 2 sons, William H and Samuel Allen....(Seth Wheaton guardian of William and Samuel) DB 39.203

* * * * *

- 1825 Jeremiah B Allen in the division of the estate of Samuel P Allen his Father draws the 1st share: the Mansion House measuring 40' on Wickenden Street; 40'3" on the N end, extending back 87' on the W and 84' on the E side with all privileges and appurtenances thereon belonging, with a woodhouse and shed at at the upper part of a gangway on the W, the shed to be severed from the other part of the woodhouse, valued at \$2350....Deed Book 51.210
- 1829 Jeremiah B Allen sells for \$800 to Hervey Armington his share of the real estate of his father Samuel P Allen the above property with the benefit of a gangway to be kept open....Deed Book 57.88
- 1854 TAX LEDGER: Hervey ~~Allen~~^{Armington} (M.D.) Flat 16...Lot 467...Value of Land \$1302 Value of Building \$1500...TL A1.23
- 1896 TAX LEDGER: Hannah Armington et al...Flat 16...Lot 467..Value of Land \$1860...Value of Building \$1600...El.183
- 1904 Hannah B Armington et al, by her lawful attorney, sells to A Wallace Anderson and Sarah J Anderson, his wife, all of the following pre-

more...

sent to
Ms May N Stone
315 E 68th St - Apt 9-0
NY NY 10021
also data - 255 So. Main St.

#166 WICKENDEN STREET...continued

scribed real estate as follows: Situated on the N/ly side of Wickenden Street on which it measures 40'; W by a gangway and Mary C and Emma R Edwards 87'; N by the estate of Peleg Sherman 40' 3"; E by heirs of Solomon Ingraham 84', being the same premises acquired by said grantors u/ws of Hervey Armington their Father, and Rebecca B and Emily Armington their sisters, and being further described as Lot #467 on the Assessor's Plat #16, and are the same premises apportioned to Jeremiah B Allen out of his Father's Estate, samuel P Allen..(DB 51.210) . Deed Book 459.342

- 1917 The above property was taxed to the Sarah J Anderson Estate and to the following persons in the year designated:
- 1919 Carl J Carlson and wife Ingrid J
- 1923 Albert J Scott and wife Alberta E
- 1936 Frank C Aldrich and wife Edythe E
- 1968 Carl Adler and Wife Elizabeth R $\frac{1}{2}$ and Irving ^H Adler and wife Eleanor T $\frac{1}{2}$
- 1969 We, Carl Adler and Elizabeth R Adler, his wife, and Irving Adler and Eleanor Adler, his wife, sell to Erwin W Deimes jr and wife Mercedes that lot of land with all buildings and improvements thereon situated on the N/ly side of Wickenden in the City of Providence R I bounded: S/ly by Wickenden Street 40'; W/ly partly on the E/ly line of and old gangway and partly on land of Abraham Herman et al 87'; E/ly by Mabel Turner 84'; N/ly by Angelina R Cotta et al 40' 3". Also all our right, title and interest in the gangway above referred to, being the same premises conveyed to these grantors by Frank C Aldrich and Edythe E Aldrich in 1968....Deed Book 1154.1104-5

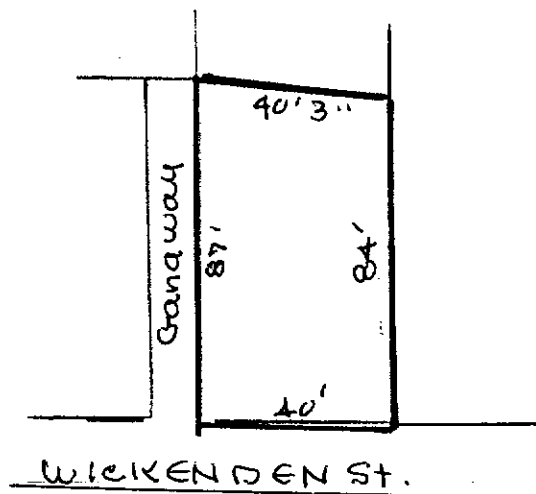

Mary A Gowdey
researcher
October 1975